

vtech[®]

Parent's Guide

My Playful Kitten



VTech understands that a child's needs and abilities change as they grow and with that in mind we develop our toys to teach and entertain at just the right level...

vtech Baby

Toys that will stimulate their interest in different textures, sounds and colours

I am...

...responding to colours, sounds and textures

...understanding cause and effect

...learning to touch, reach, grasp, sit-up, crawl and toddle

Birth-36 months



Pre-School

Interactive toys to develop their imagination and encourage language development

I want...

...to get ready for school by starting to learn the alphabet and counting

...my learning to be as fun, easy and exciting as can be

...to show my creativity with drawing and music so my whole brain develops

3-6 years



Electronic Learning Computers

Cool, aspirational and inspiring computers for curriculum related learning

I need...

...challenging activities that can keep pace with my growing mind

...intelligent technology that adapts to my level of learning

...National Curriculum based content to support what I'm learning at school

4-10 years



To learn more about this and other VTech® products, visit www.vtech.co.uk

INTRODUCTION

Thank you for purchasing the **My Playful Kitten**.

Play and learn with this lively kitten. Shake the wand in front of the kitten and see how it runs and plays. Care for this interactive kitty to hear how it is feeling and learn about colours, numbers, kitten facts, music and songs.

On/Off/Mode Switch

3 Number &
Colour Buttons

IR Sensor

Wand With Toy Fish



INCLUDED IN THE PACKAGE

- My Playful Kitten
- One Wand
- Parent's Guide

WARNING

All packing materials such as tape, plastic sheets, packaging locks, removable tags, cable ties, cords and packaging screws are not part of this toy and should be discarded for your child's safety.

NOTE

Please keep this Parent's Guide as it contains important information.

Removing the Packaging Locks:

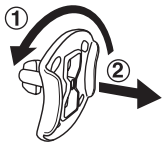

- ① Rotate the packaging locks anticlockwise 90 degrees.
- ② Pull out the packaging locks and discard.

NOTE

Please cut and discard the plastic strap that attaches the **My Playful Kitten** to the box. The strap is not part of this toy and should be discarded for your child's safety.

NOTE

Keep your body, hair and clothing away from the moving kitty. If something gets caught in the kitty's wheel, turn the kitty **Off** by sliding the **On/Off/Mode Selector** to the **Off** position.

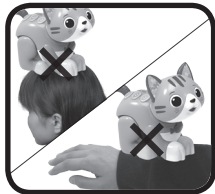

ACTIVATE NORMAL PLAY MODE

The **My Playful Kitten** is in Try-Me mode in the package. To activate normal play mode, please follow the below steps:

- 1) Turn the unit on. Press and hold the three **Number & Colour Buttons** together for at least three seconds.
- 2) You will hear two short sounds to indicate that normal game play has been activated.

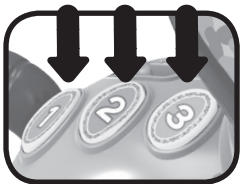

GETTING STARTED

BATTERY REMOVAL AND INSTALLATION

1. Make sure the unit is turned **Off**.
2. Find the battery cover located on the bottom of the unit, use a screwdriver to loosen the screw and then open the battery cover.
3. If used batteries are present, remove these batteries from the unit by pulling up on one end of each battery.
4. Install 4 new AA (AM-3/LR6) batteries following the diagram inside the battery box. (For best performance, alkaline batteries or fully charged Ni-MH rechargeable batteries are recommended).
5. Replace the battery cover and tighten the screw to secure.

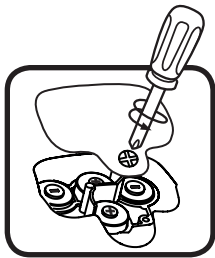

WARNING:

Adult assembly required for battery installation.
Keep batteries out of reach of children.

IMPORTANT: BATTERY INFORMATION

- Insert batteries with the correct polarity (+ and -).
- Do not mix old and new batteries.
- Do not mix alkaline, standard (carbon-zinc) or rechargeable batteries.
- Only batteries of the same or equivalent type as recommended are to be used.
- Do not short-circuit the supply terminals.
- Remove batteries during long periods of non-use.
- Remove exhausted batteries from the toy.
- Dispose of batteries safely. Do not dispose of batteries in fire.

RECHARGEABLE BATTERIES:

- Remove rechargeable batteries from the toy before charging.
- Rechargeable batteries are only to be charged under adult supervision.
- Do not charge non-rechargeable batteries.

Disposal of batteries and product



The crossed-out wheellie bin symbols on products and batteries, or on their respective packaging, indicates they must not be disposed of in domestic waste as they contain substances that can be damaging to the environment and human health.

The chemical symbols Hg, Cd or Pb, where marked, indicate that the battery contains more than the specified value of mercury (Hg), cadmium (Cd) or lead (Pb) set out in the Batteries and Accumulators Regulation.



The solid bar indicates that the product was placed on the market after 13th August, 2005.

Help protect the environment by disposing of your product or batteries responsibly.

VTech® cares for the planet.

Care for the environment and give your toy a second life by disposing of it at a small electricals collection point so all its materials can be recycled.

In the UK:

Visit www.recyclenow.com to see a list of collection points near you.

In Australia & New Zealand:

Check with you local council for kerbside collections.

PRODUCT FEATURES

1. On/Off/Mode Selector

To turn the unit **On**, slide the **On/Off/Mode Selector** to Learning Mode 🐾 or Music Mode 🎵. You will hear a song, playful phrases and sounds. To turn the unit **Off**, slide the **On/Off/Mode Selector** to the **Off** position.



2. Number and Colour Buttons

Press the three **Number and Colour Buttons** to learn numbers, colours and kitten facts, as well as hear fun songs and melodies.

3. Wand With Toy Fish

Wave the wand in front of the kitty to see it move towards the fish and stand up. There is a sensor in the kitty's neck that can detect movement. Be sure to wave the wand in front of it's face and neck.

4. Automatic Shut-Off

To preserve battery life, the **My Playful Kitten** will automatically shut off after 60 seconds without input. The unit can be turned on again by sliding the **On/Off/Mode Selector**. The unit will also automatically turn off when the batteries are very low.

NOTE

If the unit powers down or the light fades out during play, please install a new set of batteries.

ACTIVITIES

1. Learning Mode

Press the three **Number and Colour Buttons** to learn about numbers, colours and facts about the kitten. Wave the **Wand** in front of the kitten to hear fun phrases and kitten sounds and to see it play with the fish.



2. Music Mode

Press the three **Number and Colour Buttons** to hear fun songs and melodies. When a song or melody is playing, wave the **Wand** in front of the kitten to hear kitten sounds and fun cartoon sounds with the songs and melodies.



MELODIES

1. Bingo
2. Alphabet Song
3. Are you Sleeping?

SONG LYRICS

Song 1

Hickory dickory dock,
The mouse went up the clock.
The clock struck one, the mouse ran down,
I chased him out of the house.
If he comes back, I'll tell him,
My house is no place for a mouse.

Song 2

Won't you come and play with me?
Tell me what colours you see.
Can you find something purple... just like me?
Orange, yellow and green,
Red and blue are pretty cool,
But purple is my favorite.
Because I'm purple!

Song 3

Oh, I'm a jolly good kitty,
I'm a jolly good kitty,
I'm a jolly good kitty,
Unless I get angry.
Sometimes I get angry,
it makes me want to hiss,
To make me feel better,
Scratch my ears, give me a kiss.

CARE & MAINTENANCE

1. Keep the unit clean by wiping it with a slightly damp cloth.
2. Keep the unit out of direct sunlight and away from any direct heat sources.
3. Remove the batteries if the unit will not be in use for an extended period of time.
4. Do not drop the unit on hard surfaces and do not expose the unit to moisture or water.

TROUBLESHOOTING

If for some reason the unit stops working or malfunctions, please follow these steps:

1. Turn the unit **Off**.
2. Interrupt the power supply by removing the batteries.
3. Let the unit stand for a few minutes, then replace the batteries.
4. Turn the unit **On**. The unit should now be ready to use again.
5. If the unit still does not work, install a new set of batteries.

If the problem persists, please contact our Consumer Services Department and a service representative will be happy to help you

CONSUMER SERVICES

Creating and developing **VTech®** products is accompanied by a responsibility that we at **VTech®** take very seriously. We make every effort to ensure the accuracy of the information, which forms the value of our products. However, errors sometimes can occur. It is important for you to know that we stand behind our products and encourage you to call our Consumer Services Department with any problems and/or suggestions that you might have. A service representative will be happy to help you.

UK Customers:

Phone: 0330 678 0149 (from UK) or +44 330 678 0149 (outside UK)
Website: www.vtech.co.uk/support

Australian Customers:

Phone: 1800 862 155
Website: support.vtech.com.au

NZ Customers:

Phone: 0800 400 785
Website: support.vtech.com.au

PRODUCT WARRANTY/ CONSUMER GUARANTEES

UK Customers:

Read our complete warranty policy online at vtech.co.uk/warranty.

Australian Customers:

**VTECH ELECTRONICS (AUSTRALIA) PTY LIMITED –
CONSUMER GUARANTEES**

Under the Australian Consumer Law, a number of consumer guarantees apply to goods and services supplied by VTech Electronics (Australia) Pty Limited. Please refer to vtech.com.au/consumerguarantees for further information.

**Visit our website for more
information about our products,
downloads, resources and more.**

www.vtech.co.uk
www.vtech.com.au



TM & © 2021 VTech Holdings Limited.
All rights reserved.
IM-539200-000
Version:0